

**DOCO**®

INTERNATIONAL

25455

*door-solutions*

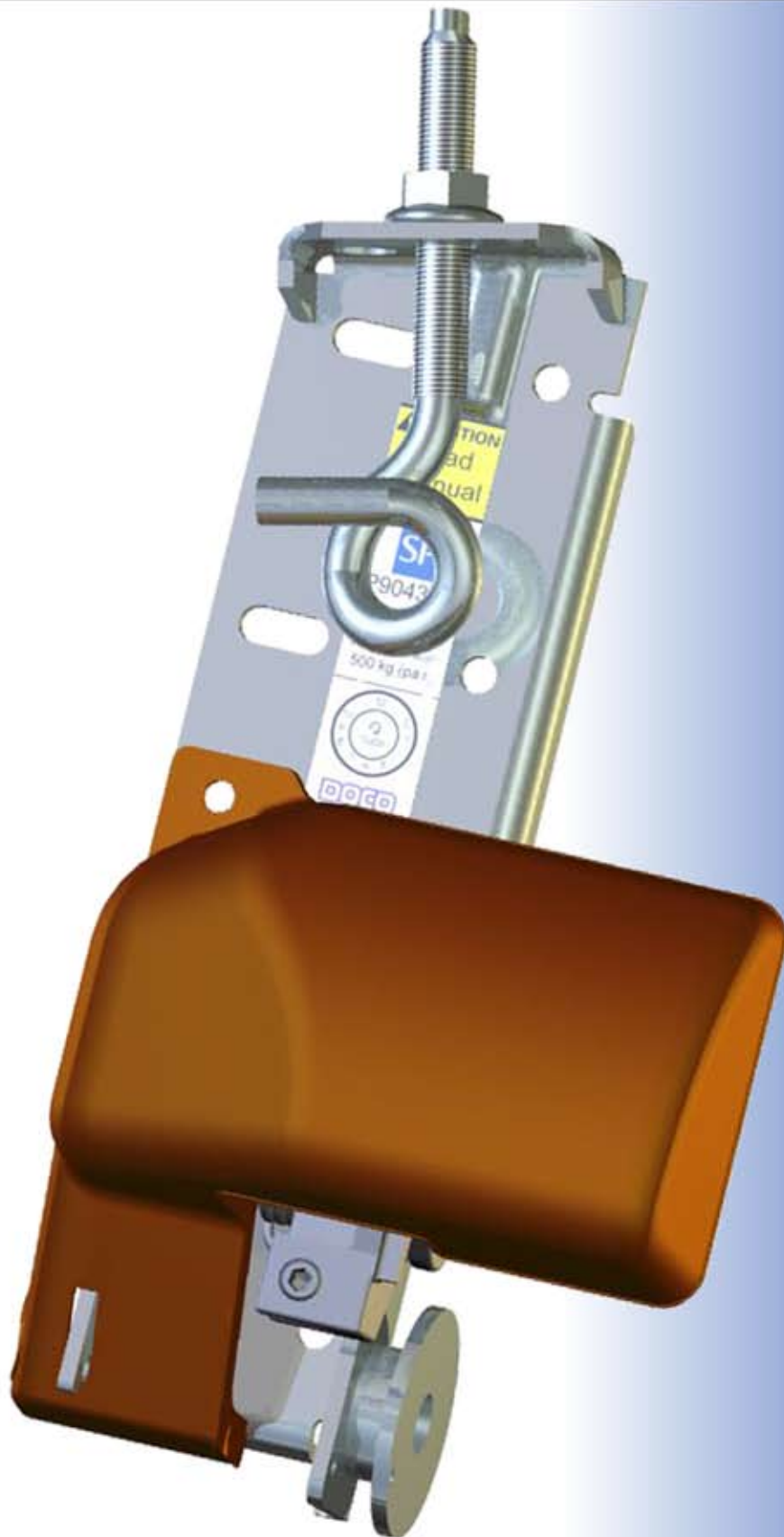

Installation manual

## 1. Symbols and warning icons.



Danger



Attention

## 2. General warnings

This manual has been prepared for use by qualified personnel and therefore it is not suitable for trainees or "DIYers". If you are in doubt about the installation and/or maintenance of this product, please contact DOCO International. To avoid severe personal injury, please carefully read and observe all indications and warnings in this manual.

- This manual describes the installation, use and maintenance of the cable break safety device 25455.
- This cable break safety device has been designed in accordance with the latest European standards; however, you should check whether this standard corresponds with your local national standard.
- All measurements are stated in millimetres unless otherwise specified.
- This manual should be kept in a safe place.
- It may be subject to technical changes without any written notice.
- If the cable break safety device has been activated, it should be replaced every time this occurs.



### 2.1 Safety requirements for installation and first use.

- This cable break safety device may only be installed by qualified personnel.
- Make sure that the power is switched off and remains switched off while electrical work is carried out!
- Adding or leaving out parts can negatively impact the operation and safety of the door and is therefore strongly discouraged!
- With regard to the installation, all references in this manual to left/right are always taken to mean as viewed from the installation location, i.e. from the inside looking out.
- Never use the sectional door in the event of visible damage to the cable break safety device.
- Secure the installation/maintenance location with safety ribbon to keep others (especially children!) at a distance.
- Maintenance must only be performed by a qualified company and/or qualified personnel

## 3. Uses

This cable break safety device can be used on manually-operated, chain-operated and electrically-operated industrial doors. The cable break safety device is suitable for sectional overhead doors with a minimum weight of 40 kg and a maximum weight of 500 kg. The door must be fitted with 2 lifting cables. The cable width should be a minimum of  $\varnothing 4\text{mm}$  and a maximum of  $\varnothing 6\text{mm}$ . A cable break safety device should be installed on each lifting cable. The diameter of the shaft should be  $\varnothing 11\text{ mm}$ . The radius of the loop should be at least 380 mm.

### 3.1 Track specifications

- Material: Wnr: 1.0226 / DX1
- Maximum hardness permitted: 90 Rockwell B
- Material thickness: 1.25 to 2 mm
- Stainless steel is not permitted
- Track type Doco.

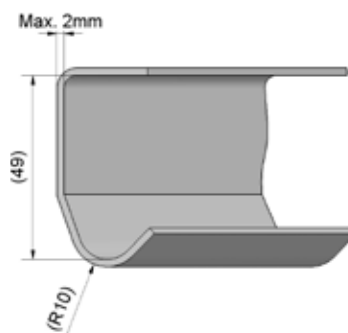

## 4. Fasteners

The fastener required to install this cable break safety device onto the door panel is not included! It is the responsibility of the installer to make sure that the installation location is strong enough, from an structural point of view, to support the cable break safety device. The installer is also responsible for using the correct fasteners. The self-tapping screw ST 6.3 x 35 (DOCO:14017) is used in the manual.

5. Descriptions

- 1. Installation plate
- 2. Rotation module
- 3. Blade
- 4. Protective tape
- 5. Adjustable nut
- 6. Adjustable hook
- 7. Set screw
- 8. Split pin
- 9. Cover

- A. Installation holes
- B. Insertion socket for roller
- C. Holes for installing split pin.
- D. Holes for installing E-switch
- E. Installing cable
- F. Installing guard
- G. Installing guard
- H. Hole for pull cord.

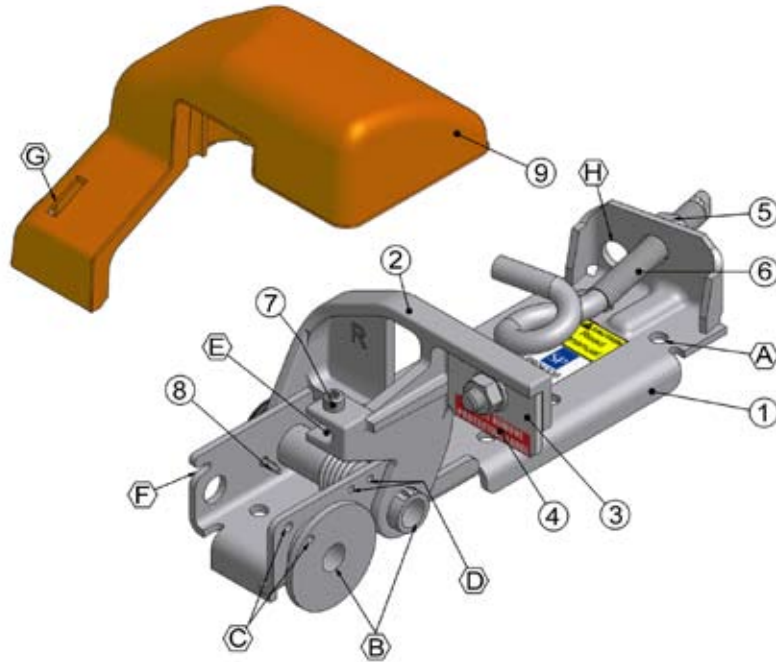

6. Principle of operation

The tightening of the springs will put tension on the cables. This tension ensures that module two will be in the open position. The blade (3) should be free from the track rails. In the event of a cable break, the cable tension will be released. This will cause the module to turn due to spring tension. The blade (3) will cut through the track rails, jamming them. This will also jam the door leaf. If an E-switch has been installed, this will ensure that the electrical drive is switched off.

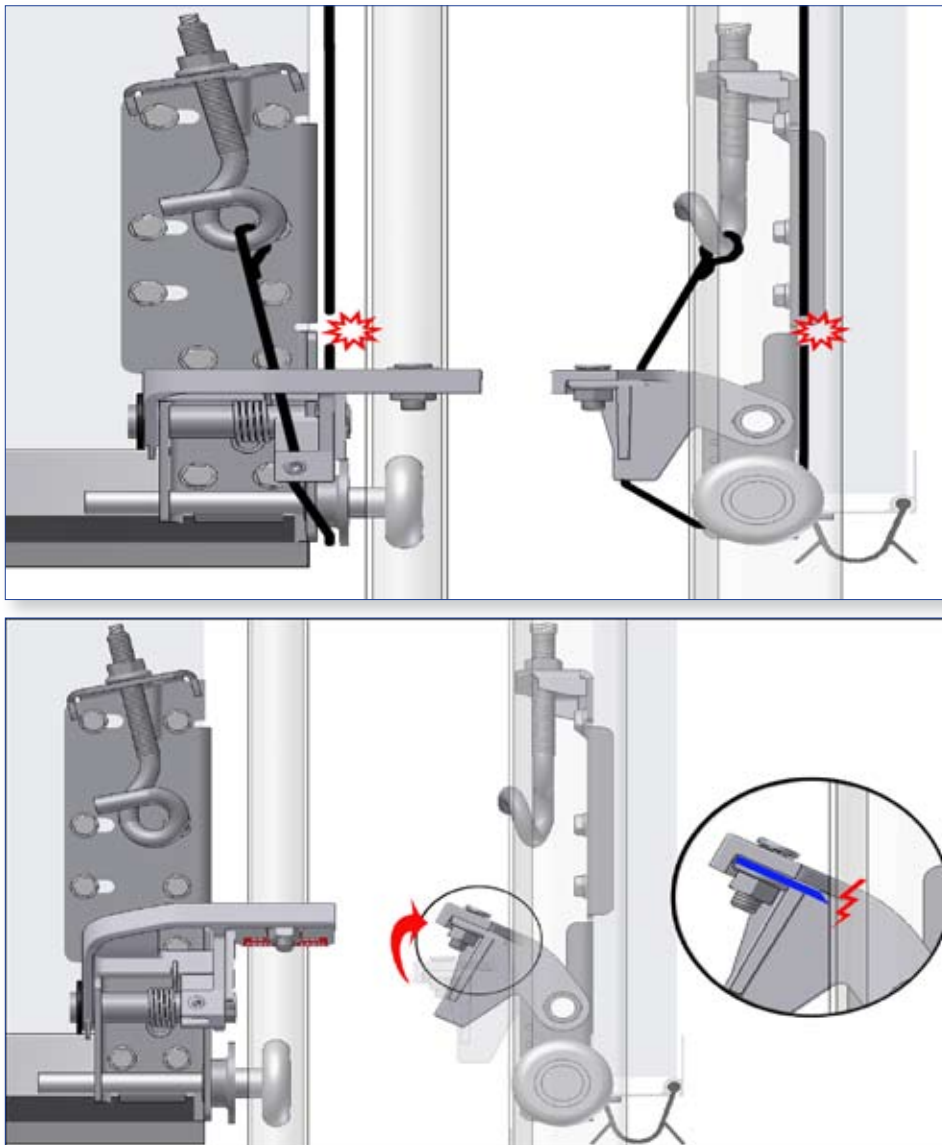

## 7 Installation

This installation manual describes the installation of a right-side cable break safety device. Every door will be installed with one right-side and one left-side cable break safety device.

### 7.1 Step-by-step instructions

- A: Install the cable break safety device. The construction area must be flat.
- B: Install the roller in one of the insertion sockets (B). Install the lowermost door panel between the rail sets.
- C: Line up the door panel in such a way that the rail ends up in the middle of the blade.
- D: Remove the split pin (8). Check the rotation module (2) to ensure that it can move smoothly. Re-install the split pin (8). The rotation module is now locked open.

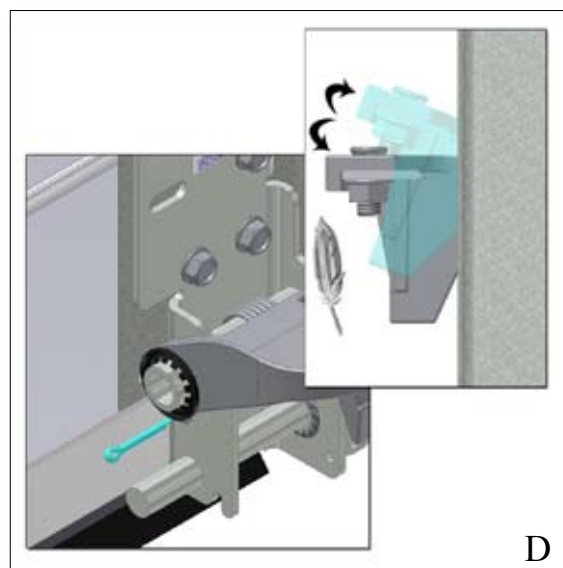
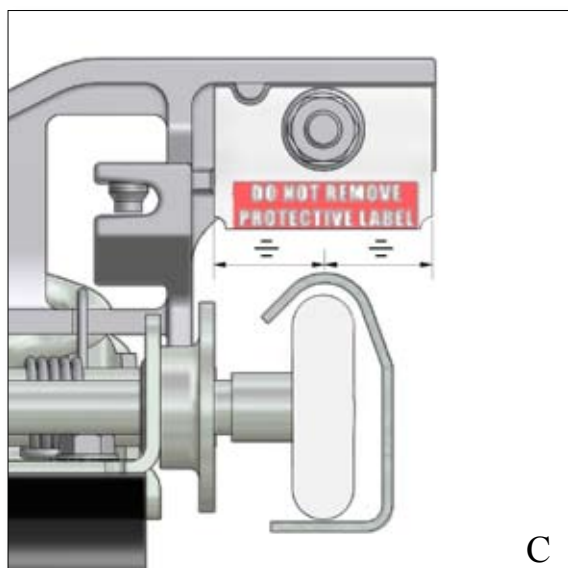
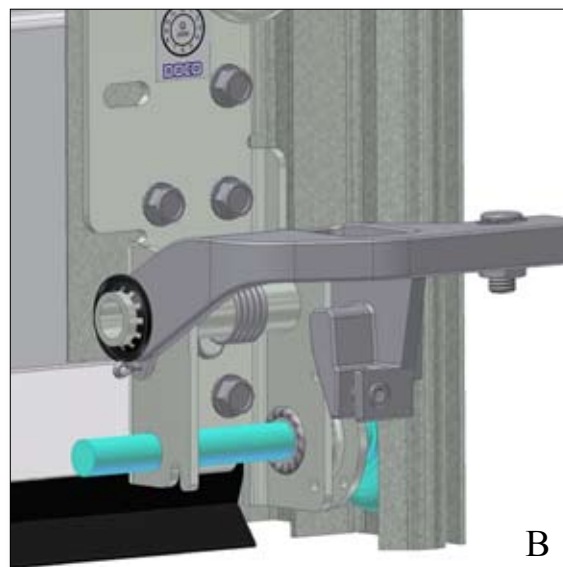
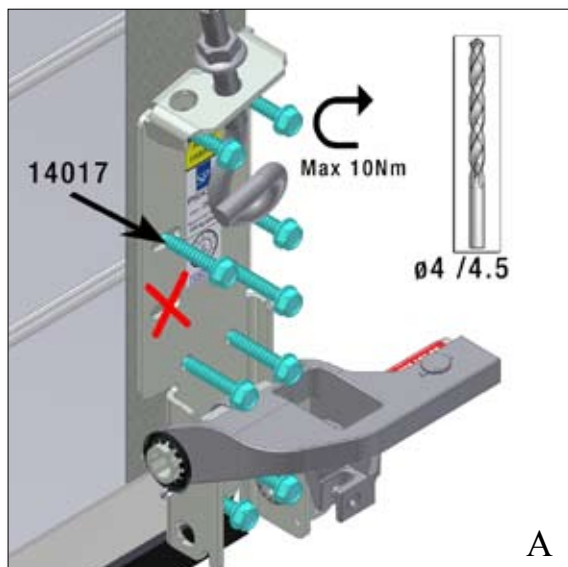

- E: Install the cable as shown in the diagram. Complete the door panel installation and tension the springs.
- F: Make sure the cable tension is equal on the left- and right-hand sides. You can adjust the cable tension using the adjustable nut (5). The cable should be able to move freely at its point of affixation (E).
- NOTE: Only release tension if this will cause unequal cable tension, which could cause the installation plate to protrude. Screw the set screw (7) tightly.
- G: Remove the split pin (8).
- H: Install the guard (9).
- I: Finish.

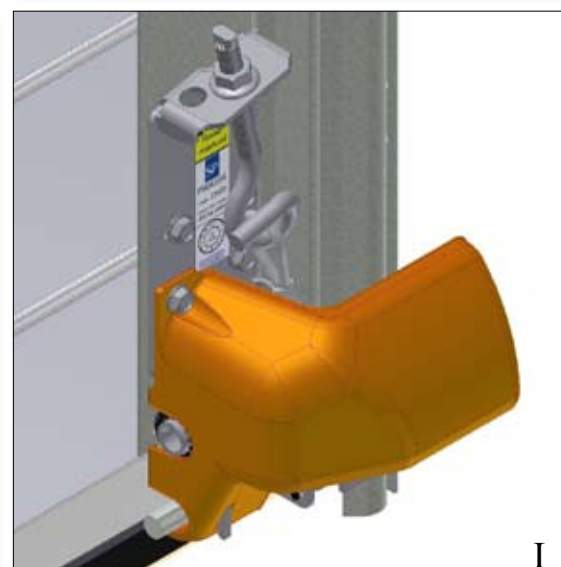
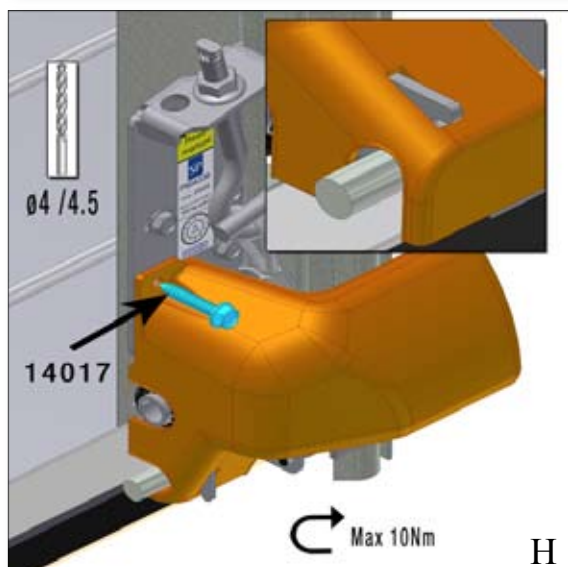
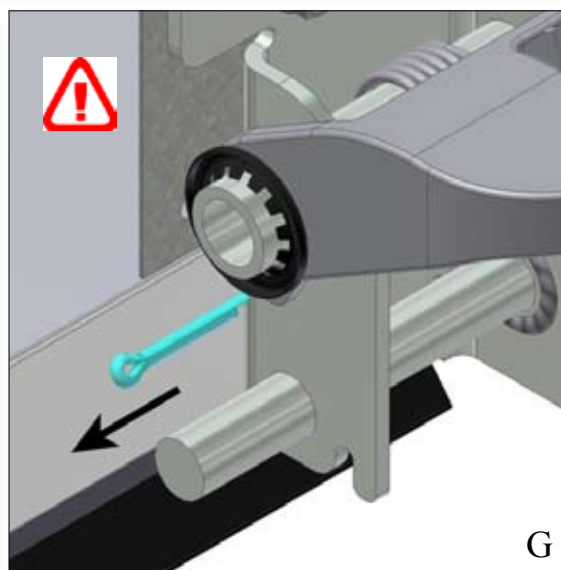
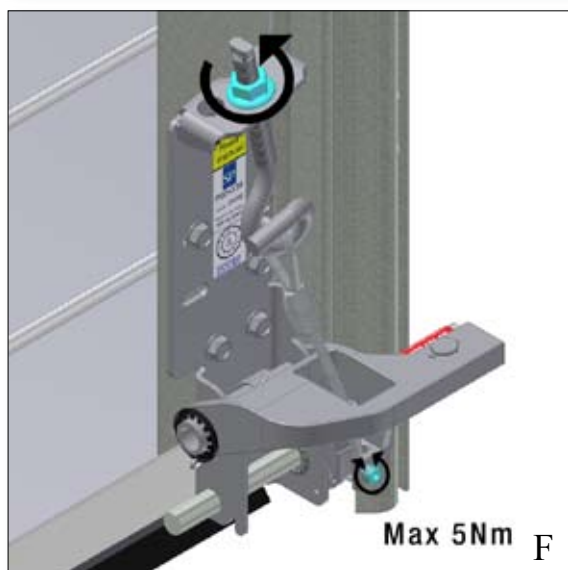
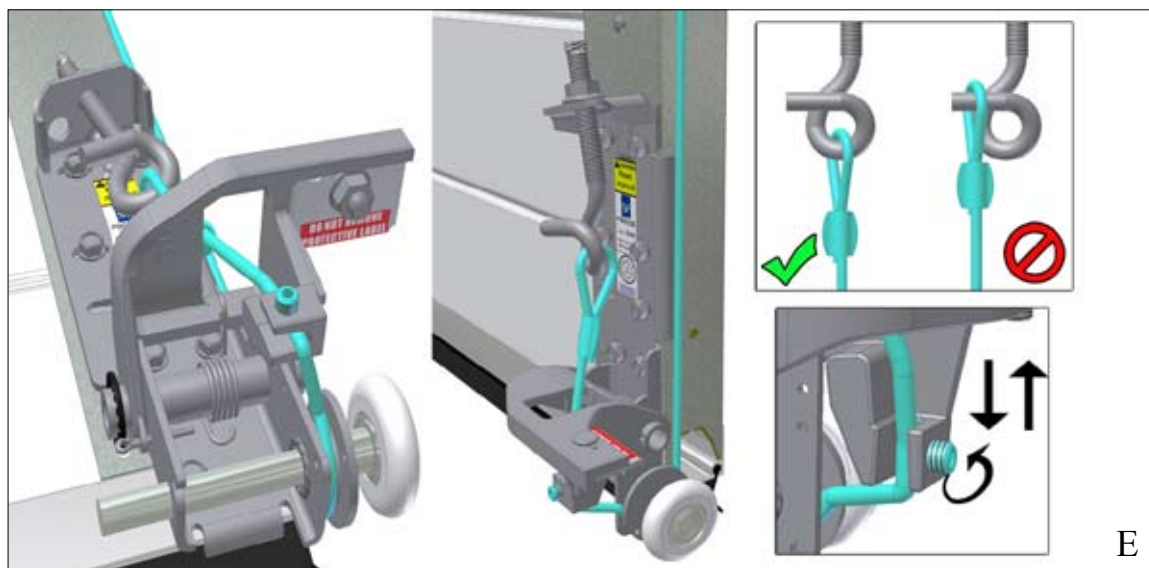

### 7.2 Installation of the low head-room/standard lift.

If the lowermost door panel travels around the curved section, the cable must be secured. This can be done using the split pin (8). Secure the cable as shown in the diagram below.

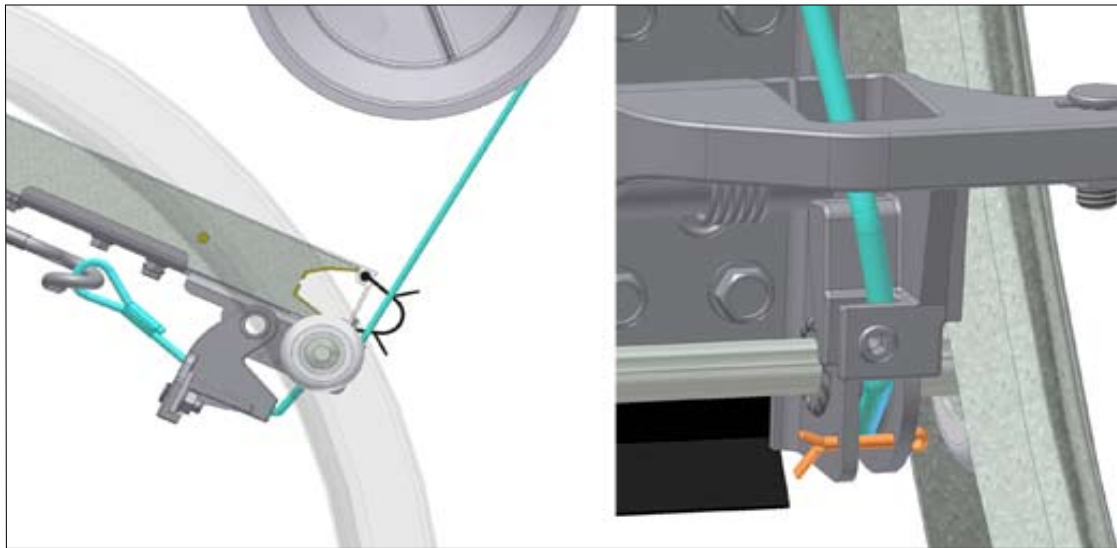

### 7.3 Installation of the E-switch (25445).

The cable break safety device can be fitted with an E-switch. This will turn off the motor in the event of a cable break. Install the switch as shown in the diagram below.

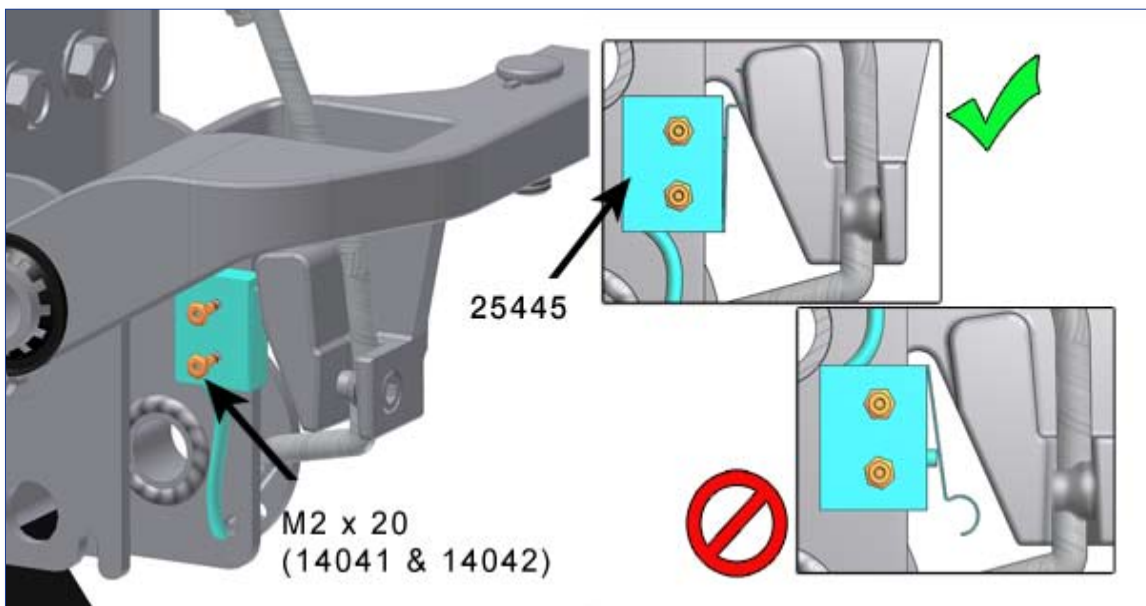

## 8. Testing/maintenance

In principle, the cable break safety device should be maintenance-free. However, we do advise you to check for debris and to remove any debris on a regular basis.

## 9. Replacement after a cable break safety device has been activated.

The replacement of cable break safety devices may only be carried out by qualified installation personnel.

If, during replacement, the (overhead) door is not in a normal condition, you must ensure that the door blade is secured at all times, in such a way that the door blade cannot move downwards.

Step 1: Secure the door blade, for example by using struts.

Step 2: Now push the door blade further up, so that the blade separates from the rails. Temporarily secure the module with the split pin, in such a way as to jam the module.

Step 3: Lock the door. Release the springs to take any tension off the cable.

Step 4: Check all parts of the door for damage and replace any parts if necessary. Remove the burr in the rails if this is not to be replaced.

Step 5: Replace both of the cable break safety devices and cables in accordance with the installation instructions.

## 10. Certificate number: P904336 (SP)

This cable break safety device has been approved by the Swedish testing institute SP



Doco International B.V.  
Nusterweg 96  
6136 KV Sittard  
P.O. Box 427  
6130 AK Sittard  
The Netherlands  
Tel: +31 (0) 464200666  
Fax: +31 (0) 464526894

Doco International Limited  
Unit 1 Northolt Trading  
Estate  
Belvue Road  
Northolt Middlesex  
UB5 5QS  
United Kingdom  
Tel: +44 (0) 20 8839 8587  
Fax: +44 (0) 20 8842 3661

Doco International  
Components s.l.u  
P.I. Can Met Sidro  
Avenida Generalitat, 55  
08530 La Garriga /  
Barcelona  
España / Spain  
Tel: +34 9 3 861 28 25  
Fax: +34 9 3 871 65 92

Doco International s.r.o.  
Prostějov - Kralice na Hané  
Háj 352  
798 12 Kralice na Hané  
Czech Republic  
Tel: +420 582 360 100  
Fax: +420 582 360 300